

# ARRANJO NOVO - ESCOLA MUNICIPAL JOÃO MATIAS

## DETALHES

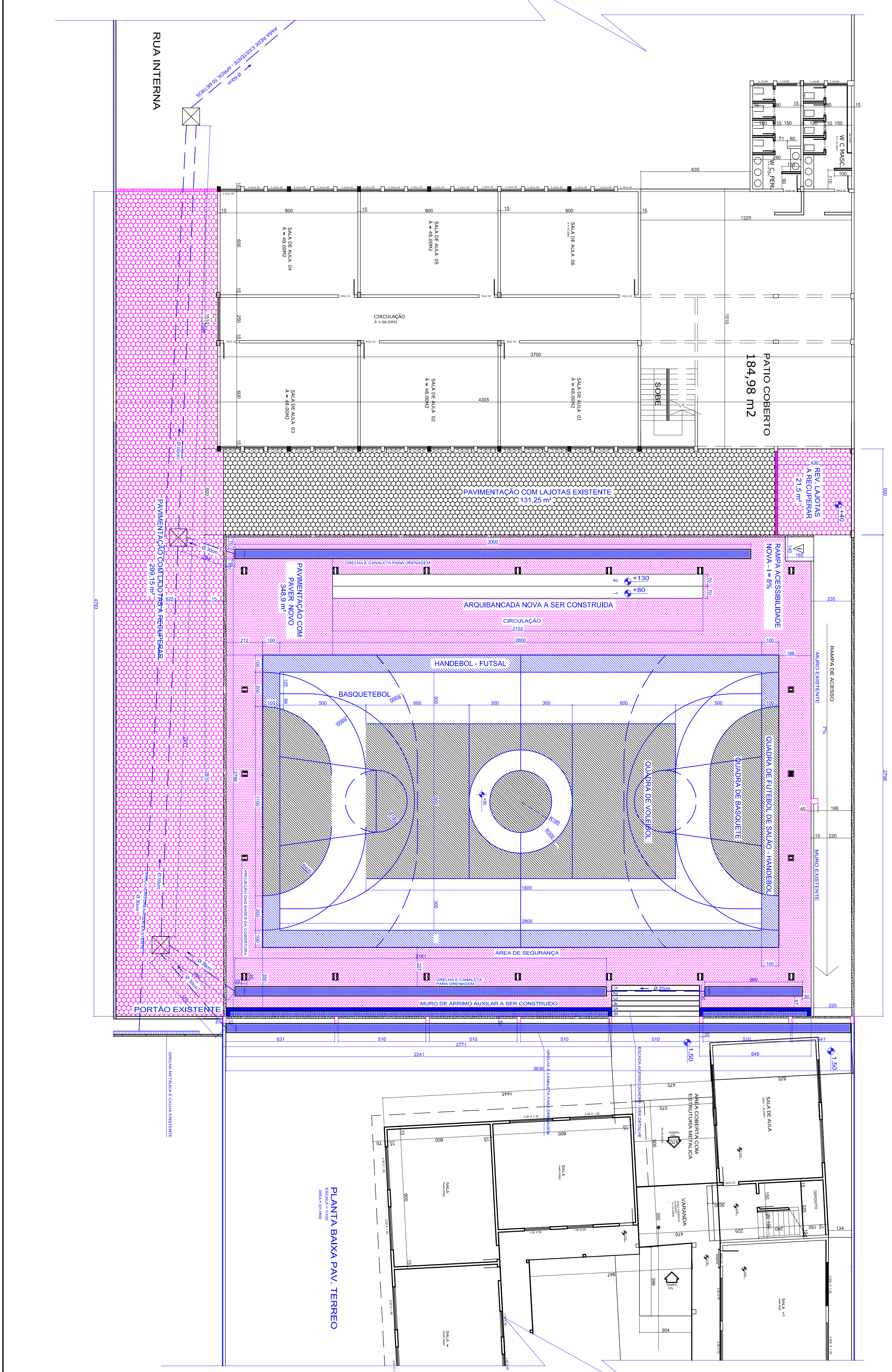

DETALHAMENTO ESCADA ACESSO À QUADRA

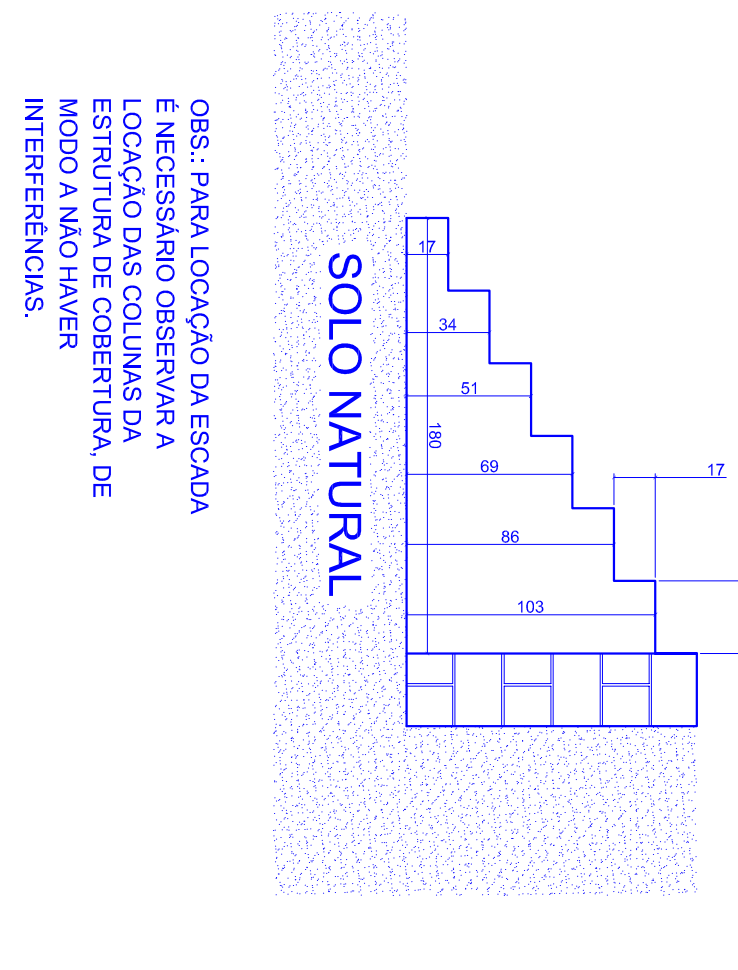

DETALHAMENTO CALHA COLETOIRA ÁGUA

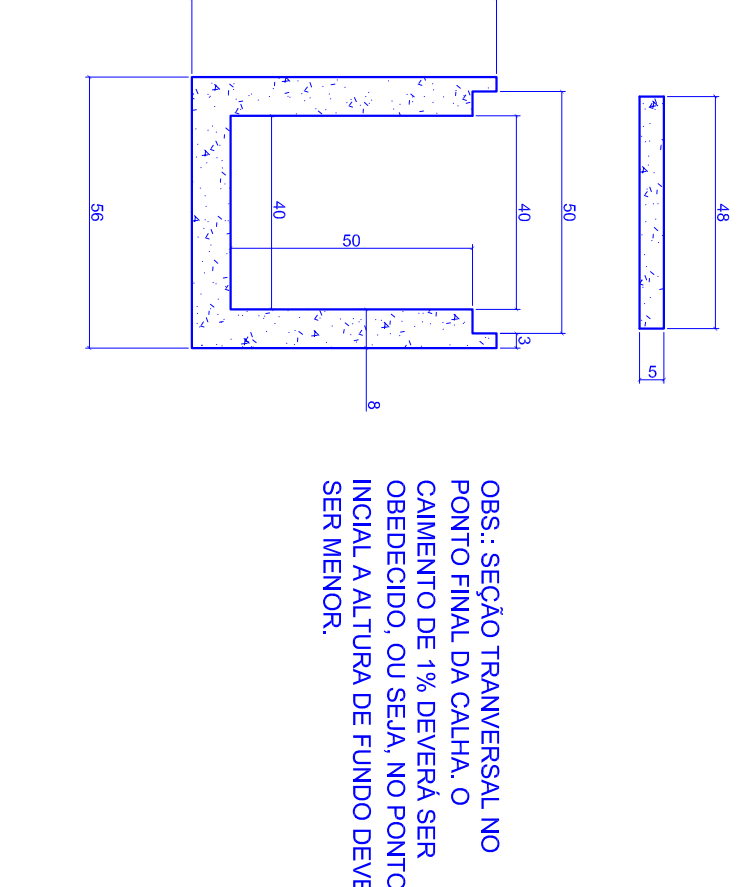

DETALHAMENTO MURO ARRIMO AJUJALAR

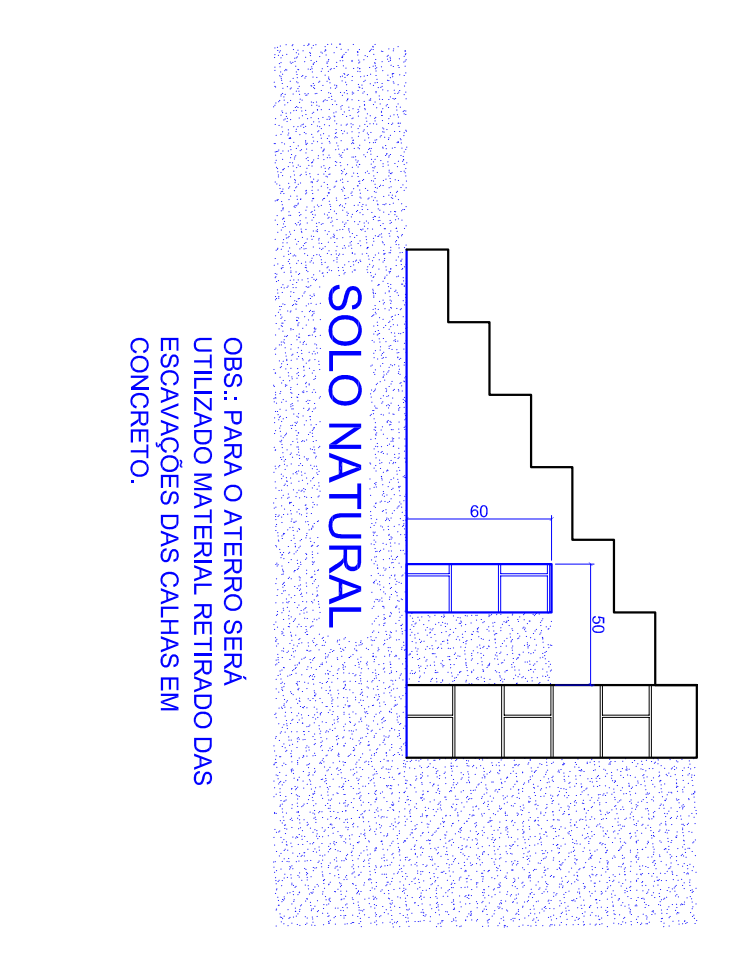

DETALHAMENTO DAS TRAVES E TABELAS

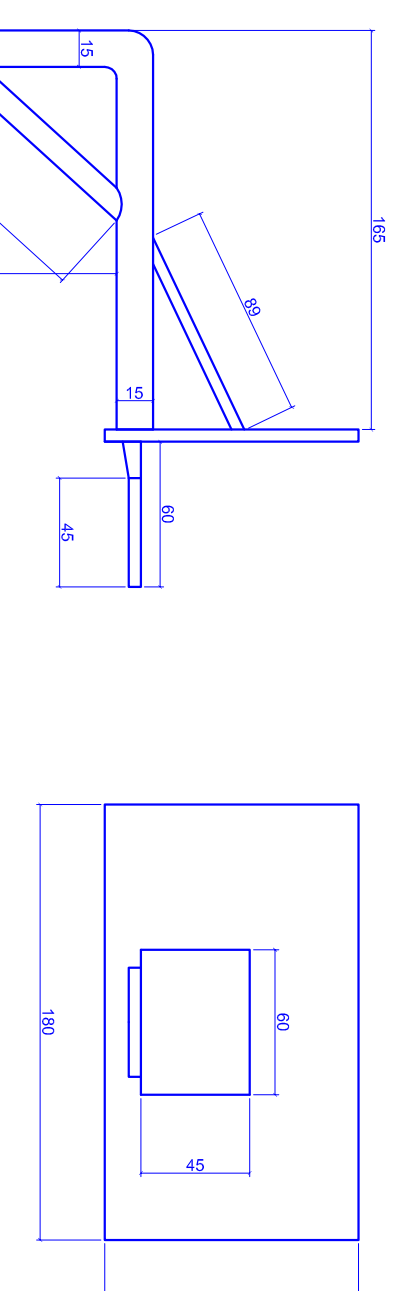

DETALHAMENTO ARQUIBANCADA QUADRA

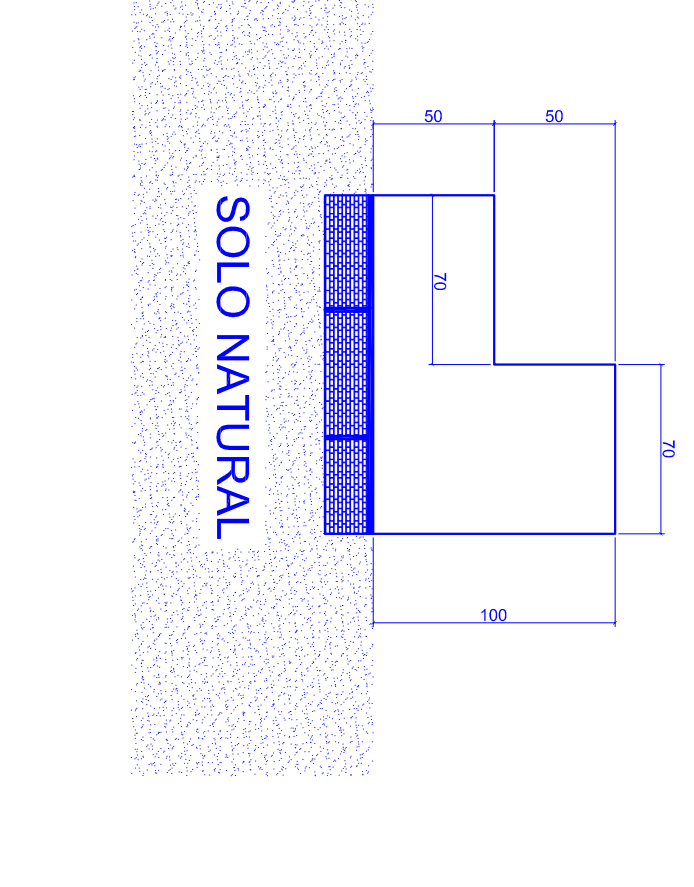

DETALHE TABELAS - 02 UNIDADES



DETALHE TRAVES - 02 UNIDADES



DETALHE SUPORTE REDE VOLEI - 02 UNIDADES

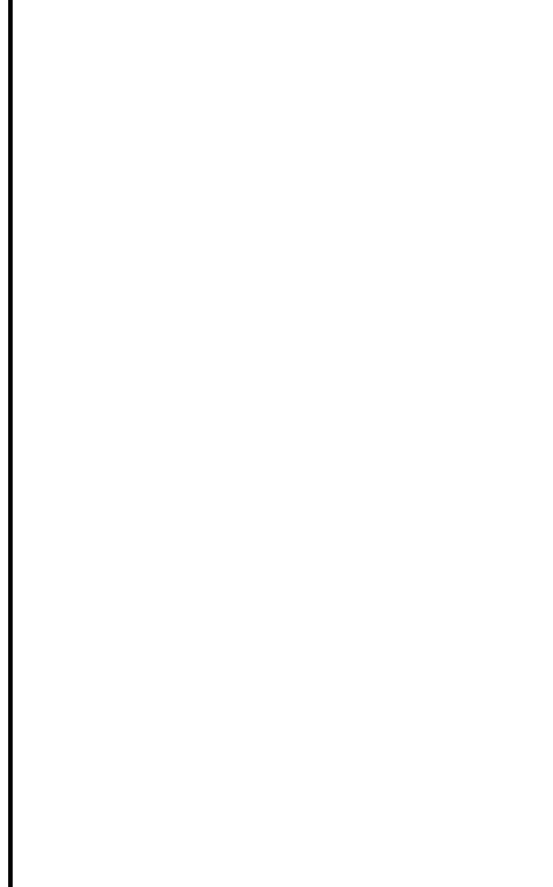

DETALHAMENTO CAIXA DE PASSAGEM

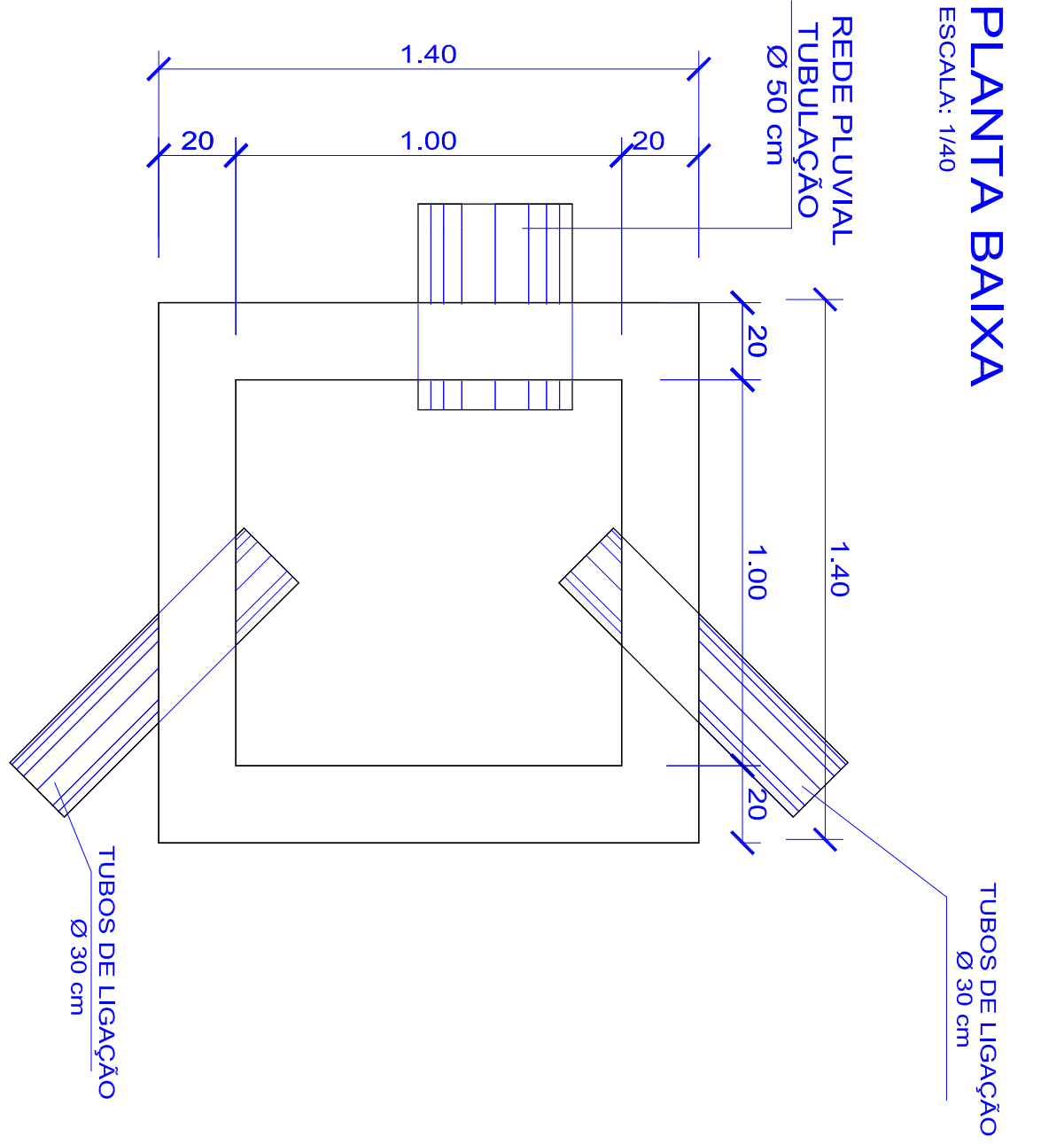

CORTE

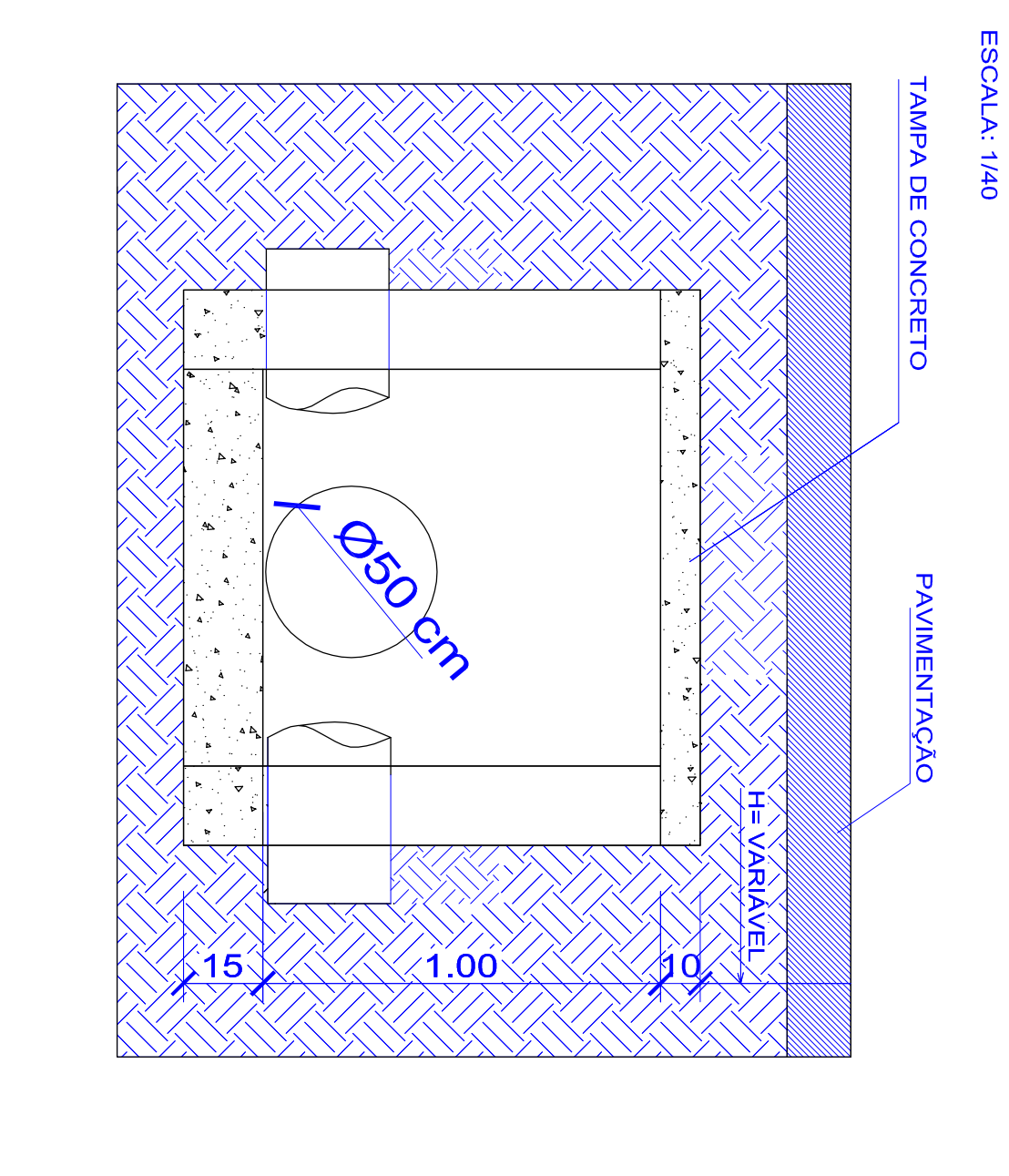

DETALHAMENTO ASSENTAMENTO DUTOS DE DREAGEM

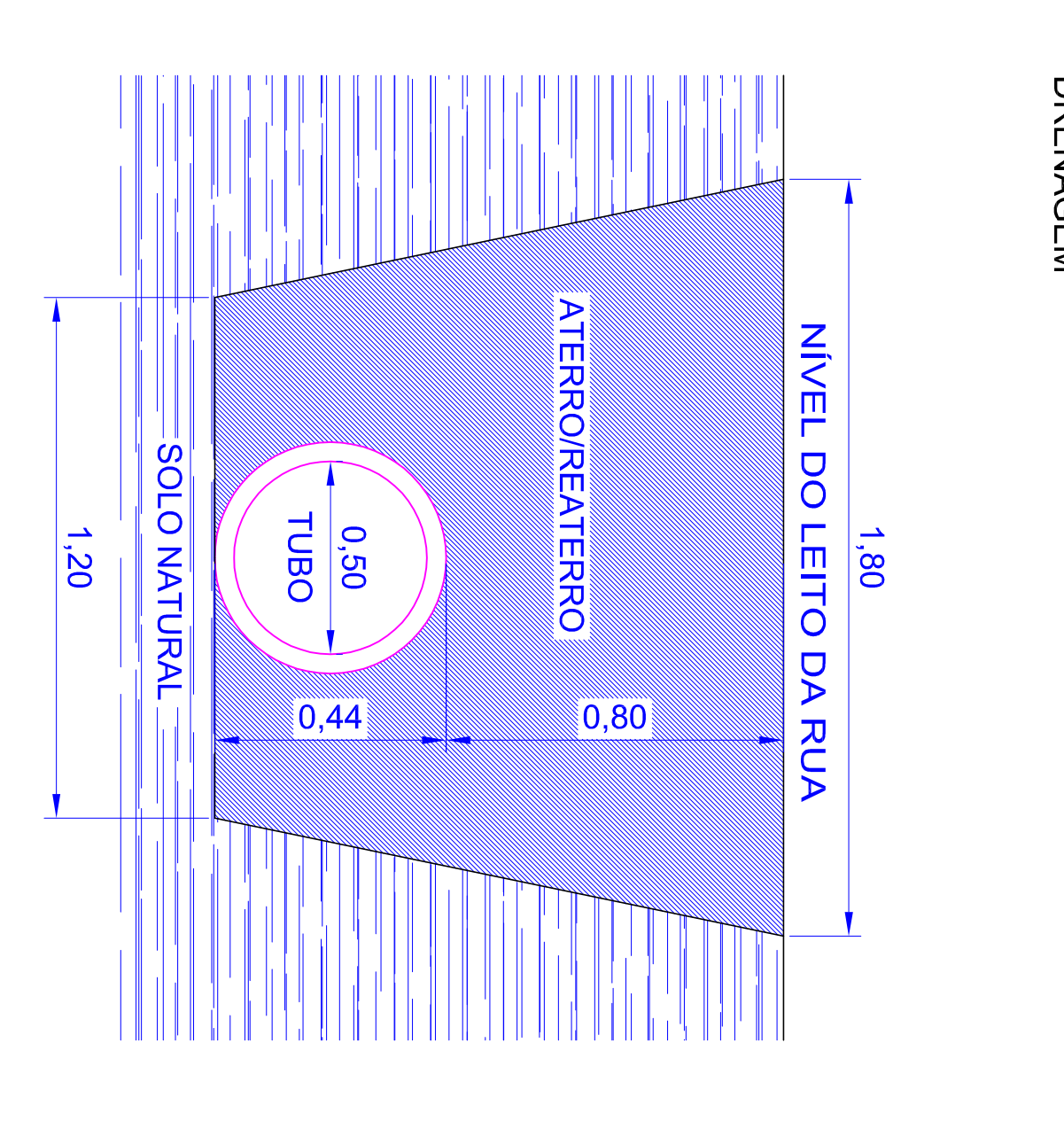

DET. ESTRUTURA TOTEM INFORMATIVO

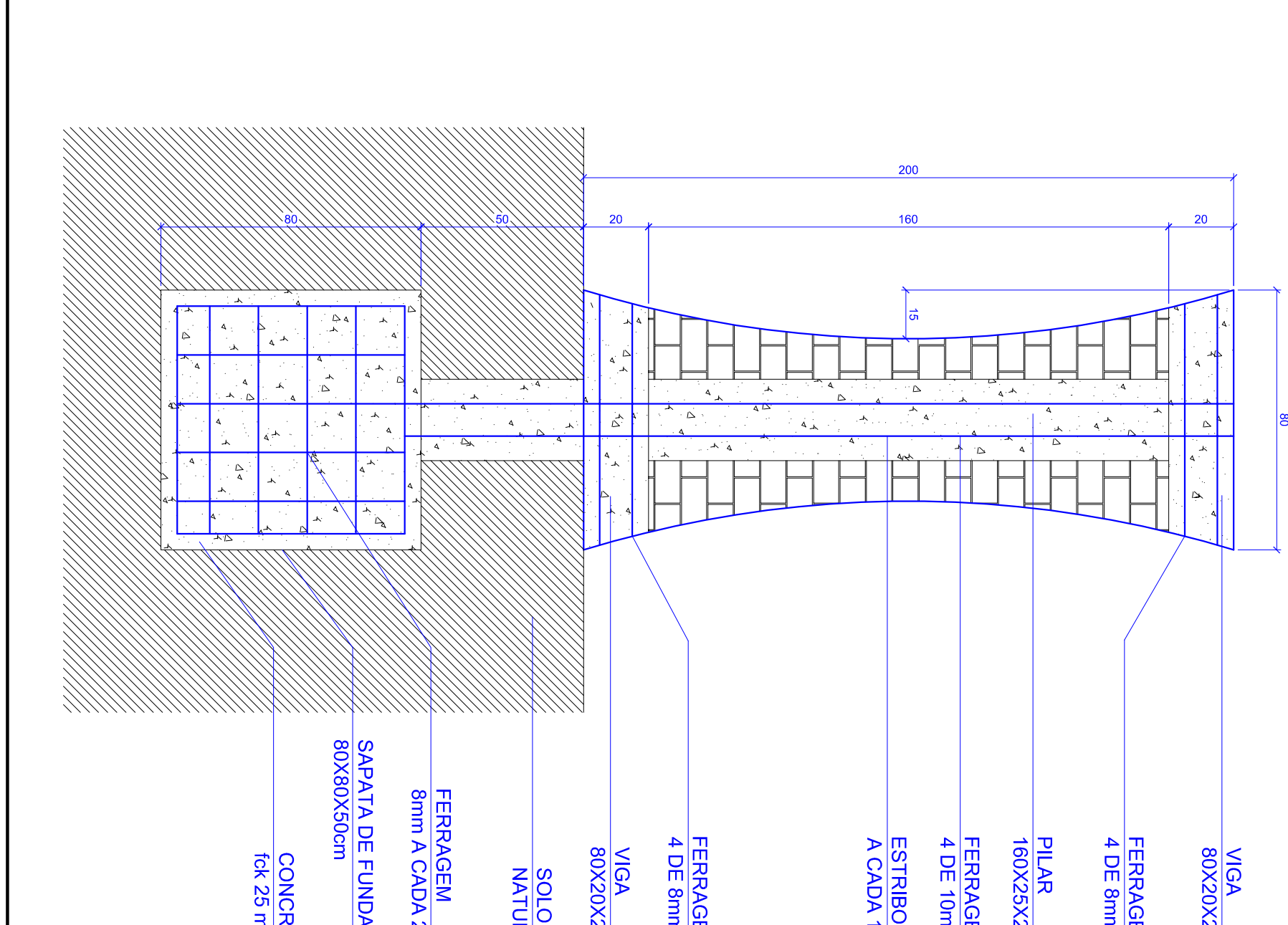

VISTA FRONTAL TOTEM

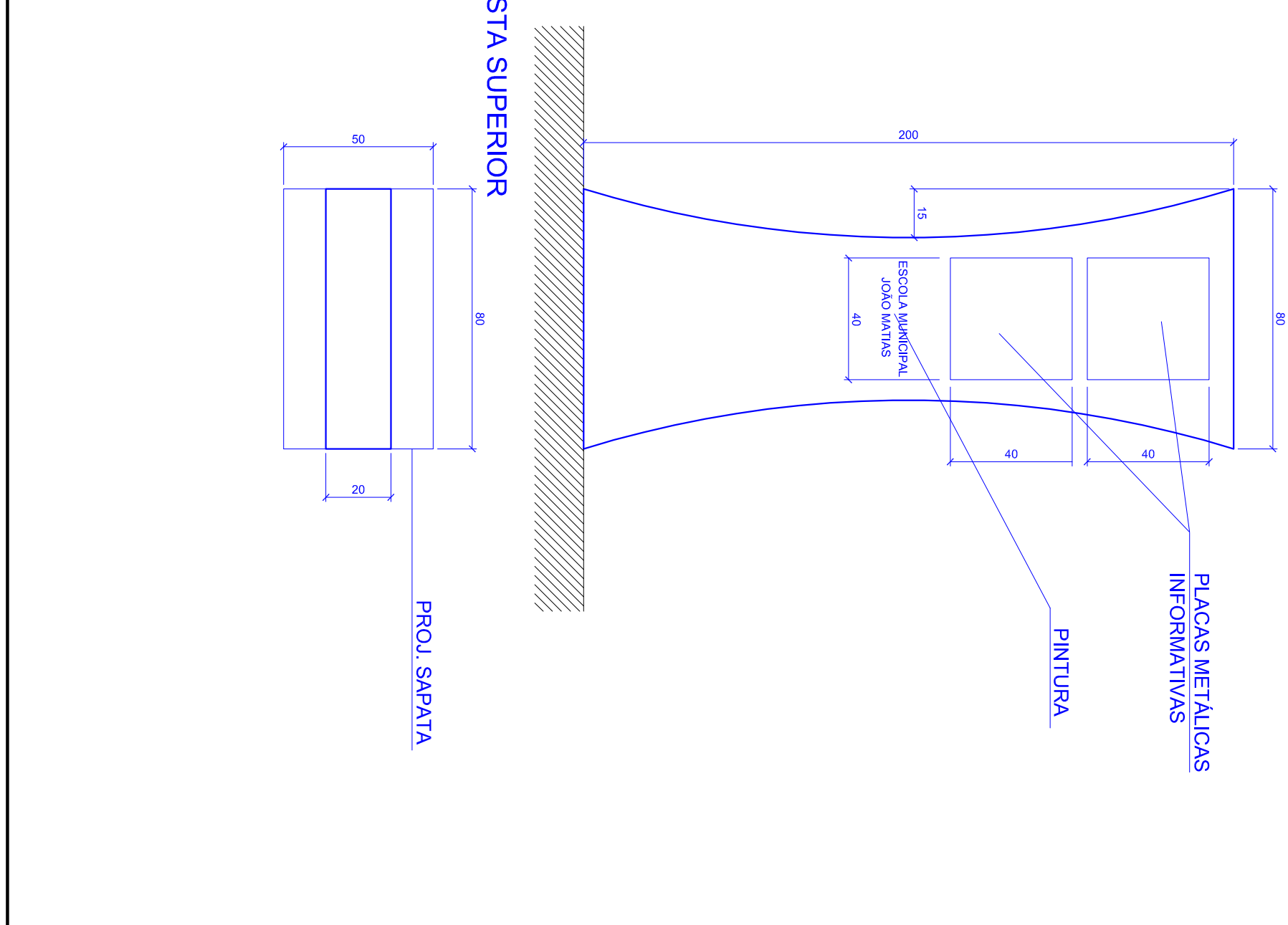

DETALHAMENTO MONTAGEM BLOCOS DE CONCRETO - LAJOTA

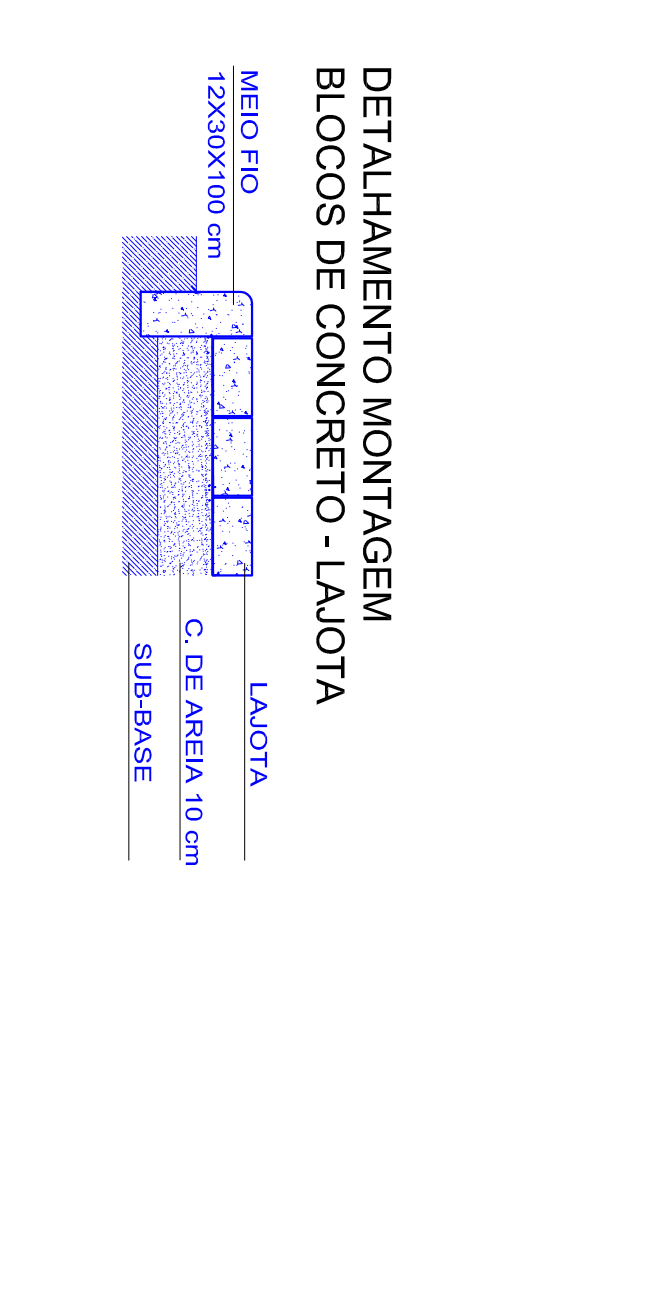

DETALHAMENTO MONTAGEM BLOCOS DE CONCRETO - PAVER

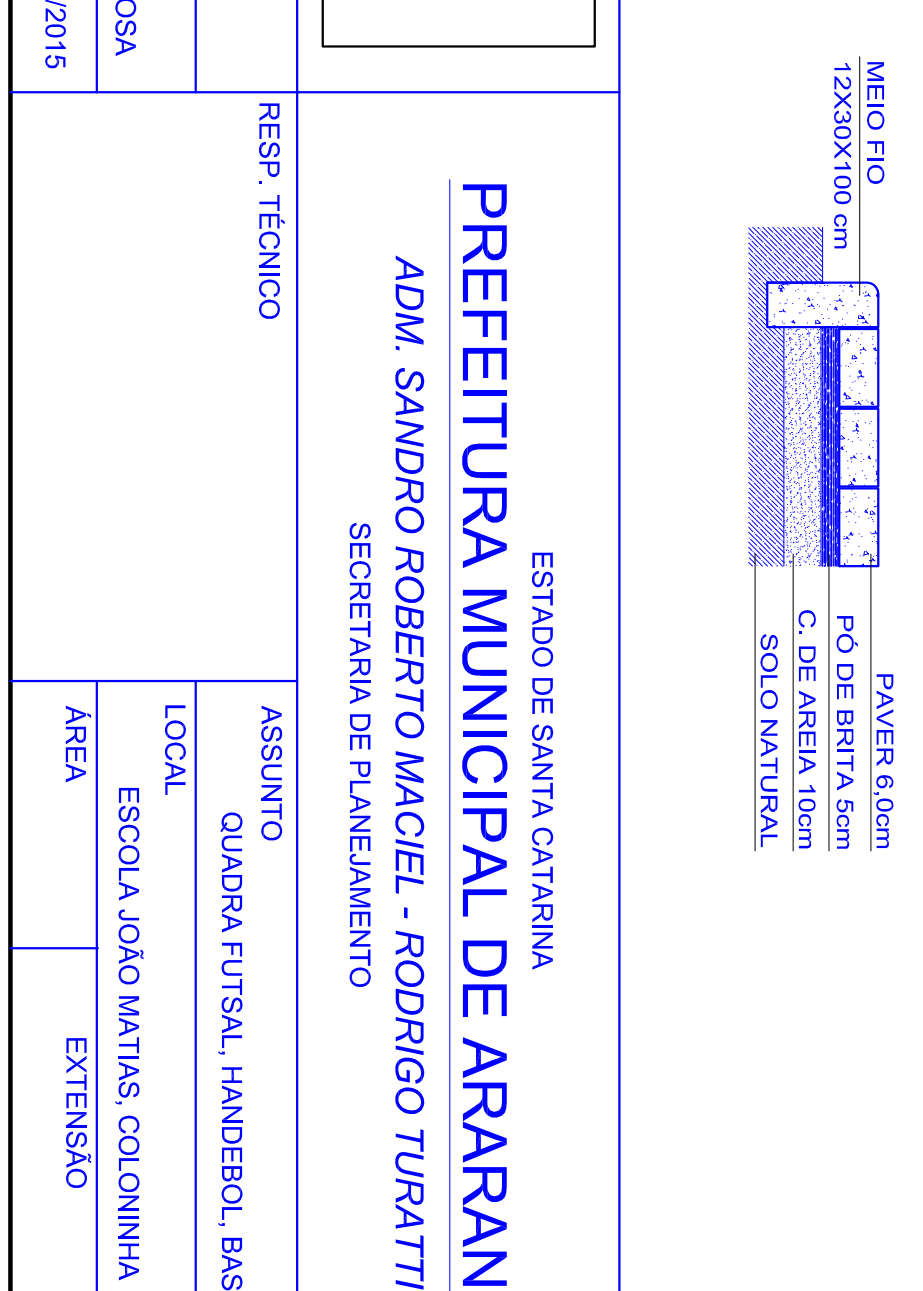

ESTADU DE SANTA CATARINA  
**PREFEITURA MUNICIPAL DE ARARANGUÁ**  
 ADM. SANDRO ROBERTO MACIEL - RODRIGO TURATTI  
 SECRETARIA DE PLANEJAMENTO

ESCALA	RESP. TÉCNICO	ASSINTO
1:125		QUADRA FUTSAL, HANDEBOL, BASQUETEBOL
PROJETO		LOCAL
DANIEL BARBERIA		ESCOLA JOÃO MATIAS COLONINA
DATA		ÁREA
MAIO/2015		ESTERNO

**03**